

Seller disclosure statement



Property Law Act 2023 section 99
Form 2, Version 1 | Effective from: 1 August 2025

WARNING TO BUYER – This statement contains important legal and other information about the property offered for sale. You should read and satisfy yourself of the information in this statement before signing a contract. You are advised to seek legal advice before signing this form. You should not assume you can terminate the contract after signing if you are not satisfied with the information in this statement.

WARNING – You must be given this statement before you sign the contract for the sale of the property.

This statement does not include information about:

- » flooding or other natural hazard history
- » structural soundness of the building or pest infestation
- » current or historical use of the property
- » current or past building or development approvals for the property
- » limits imposed by planning laws on the use of the land
- » services that are or may be connected to the property
- » the presence of asbestos within buildings or improvements on the property.

You are encouraged to make your own inquiries about these matters before signing a contract. You may not be able to terminate the contract if these matters are discovered after you sign.

Part 1 – Seller and property details

Seller SAMUEL WILLIAM TRACY AND AMBER JADE LINGWOOD

Property address 20 ALLSPICE STREET

(referred to as the "property" in this statement)

CEDAR VALE QLD 4285

Lot on plan description LOT 10 ON REGISTERED PLAN NO. 141702

Community titles scheme or BUGTA scheme:

Is the property part of a community titles scheme or a BUGTA scheme:

Yes

No

If Yes, refer to Part 6 of this statement for additional information

If No, please disregard Part 6 of this statement as it does not need to be completed

Part 2 – Title details, encumbrances and residential tenancy or rooming accommodation agreement

Title details

The seller gives or has given the buyer the following--

A title search for the property issued under the *Land Title Act 1994* showing interests registered under that Act for the property. Yes

A copy of the plan of survey registered for the property. Yes

Registered encumbrances

Registered encumbrances, if any, are recorded on the title search, and may affect your use of the property. Examples include easements, statutory covenants, leases and mortgages.

You should seek legal advice about your rights and obligations before signing the contract.

Unregistered encumbrances (excluding statutory encumbrances)

There are encumbrances not registered on the title that will continue Yes No to affect the property after settlement.

Note—If the property is part of a community titles scheme or a BUGTA scheme it may be subject to and have the benefit of statutory easements that are **NOT** required to be disclosed.

Unregistered lease (if applicable)

If the unregistered encumbrance is an unregistered lease, the details of the agreement are as follows:

- » the start and end day of the term of the lease:
- » the amount of rent and bond payable:
- » whether the lease has an option to renew:

Other unregistered agreement in writing (if applicable)

If the unregistered encumbrance is created by an agreement in writing, and is not an unregistered lease, a copy of the agreement is given, together with relevant plans, if any. Yes

Unregistered oral agreement (if applicable)

If the unregistered encumbrance is created by an oral agreement, and is not an unregistered lease, the details of the agreement are as follows:

Insert names of parties to the agreement, term of the agreement and any amounts payable by the owner of the property

Statutory encumbrances

There are statutory encumbrances that affect the property. Yes No

If Yes, the details of any statutory encumbrances are as follows:

Telstra cabling exists on the property.
See attached BYDA Plans.

Residential tenancy or rooming accommodation agreement

The property has been subject to a residential tenancy agreement or a rooming accommodation agreement under the *Residential Tenancies and Rooming Accommodation Act 2008* during the last 12 months. Yes No

If Yes, when was the rent for the premises or each of the residents' rooms last increased? (Insert date of the most recent rent increase for the premises or rooms)

Note—Under the *Residential Tenancies and Rooming Accommodation Act 2008* the rent for a residential premises may not be increased earlier than 12 months after the last rent increase for the premises.

As the owner of the property, you may need to provide evidence of the day of the last rent increase. You should ask the seller to provide this evidence to you prior to settlement.

Part 3 – Land use, planning and environment

WARNING TO BUYER – You may not have any rights if the current or proposed use of the property is not lawful under the local planning scheme. You can obtain further information about any planning and development restrictions applicable to the lot, including in relation to short-term letting, from the relevant local government.

Zoning The zoning of the property is (*Insert zoning under the planning scheme, the Economic Development Act 2012; the Integrated Resort Development Act 1987; the Mixed Use Development Act 1993; the State Development and Public Works Organisation Act 1971 or the Sanctuary Cove Resort Act 1985, as applicable*):

RURAL RESIDENTIAL - PARK LIVING.

Transport proposals and resumptions The lot is affected by a notice issued by a Commonwealth, State or local government entity and given to the seller about a transport infrastructure proposal* to: locate transport infrastructure on the property; or alter the dimensions of the property. Yes No

The lot is affected by a notice of intention to resume the property or any part of the property. Yes No

If Yes, a copy of the notice, order, proposal or correspondence must be given by the seller.

* *Transport infrastructure* has the meaning defined in the *Transport Infrastructure Act 1994*. A *proposal* means a resolution or adoption by some official process to establish plans or options that will physically affect the property.

Contamination and environmental protection The property is recorded on the Environmental Management Register or the Contaminated Land Register under the *Environmental Protection Act 1994*. Yes No

The following notices are, or have been, given:

A notice under section 408(2) of the *Environmental Protection Act 1994* (for example, land is contaminated, show cause notice, requirement for site investigation, clean up notice or site management plan). Yes No

A notice under section 369C(2) of the *Environmental Protection Act 1994* (the property is a place or business to which an environmental enforcement order applies). Yes No

A notice under section 347(2) of the *Environmental Protection Act 1994* (the property is a place or business to which a prescribed transitional environmental program applies). Yes No

Trees There is a tree order or application under the *Neighbourhood Disputes (Dividing Fences and Trees) Act 2011* affecting the property. Yes No

If Yes, a copy of the order or application must be given by the seller.

Heritage The property is affected by the *Queensland Heritage Act 1992* or is included in the World Heritage List under the *Environment Protection and Biodiversity Conservation Act 1999* (Cwlth). Yes No

Flooding Information about whether the property is affected by flooding or another natural hazard or within a natural hazard overlay can be obtained from the relevant local government and you should make your own enquires. Flood information for the property may also be available at the [FloodCheck Queensland](#) portal or the [Australian Flood Risk Information](#) portal.

Vegetation, habitats and protected plants Information about vegetation clearing, koala habitats and other restrictions on development of the land that may apply can be obtained from the relevant State government agency.

Part 4 – Buildings and structures

WARNING TO BUYER – The seller does not warrant the structural soundness of the buildings or improvements on the property, or that the buildings on the property have the required approval, or that there is no pest infestation affecting the property. You should engage a licensed building inspector or an appropriately qualified engineer, builder or pest inspector to inspect the property and provide a report and also undertake searches to determine whether buildings and improvements on the property have the required approvals.

Swimming pool	There is a relevant pool for the property.	<input checked="" type="checkbox"/> Yes	<input type="checkbox"/> No
	If a community titles scheme or a BUGTA scheme – a shared pool is located in the scheme.	<input type="checkbox"/> Yes	<input type="checkbox"/> No
	Pool compliance certificate is given.	<input checked="" type="checkbox"/> Yes	<input type="checkbox"/> No
	OR Notice of no pool safety certificate is given.	<input type="checkbox"/> Yes	<input type="checkbox"/> No
Unlicensed building work under owner builder permit	Building work was carried out on the property under an owner builder permit in the last 6 years.	<input type="checkbox"/> Yes	<input checked="" type="checkbox"/> No
	<i>A notice under section 47 of the Queensland Building and Construction Commission Act 1991 must be given by the seller and you may be required to sign the notice and return it to the seller prior to signing the contract.</i>		
Notices and orders	There is an unsatisfied show cause notice or enforcement notice under the <i>Building Act 1975</i> , section 246AG, 247 or 248 or under the <i>Planning Act 2016</i> , section 167 or 168.	<input type="checkbox"/> Yes	<input checked="" type="checkbox"/> No
	The seller has been given a notice or order, that remains in effect, from a local, State or Commonwealth government, a court or tribunal, or other competent authority, requiring work to be done or money to be spent in relation to the property.	<input type="checkbox"/> Yes	<input checked="" type="checkbox"/> No
	<i>If Yes, a copy of the notice or order must be given by the seller.</i>		
Building Energy Efficiency Certificate	If the property is a commercial office building of more than 1,000m ² , a Building Energy Efficiency Certificate is available on the Building Energy Efficiency Register.		
Asbestos	The seller does not warrant whether asbestos is present within buildings or improvements on the property. Buildings or improvements built before 1990 may contain asbestos. Asbestos containing materials (ACM) may have been used up until the early 2000s. Asbestos or ACM may become dangerous when damaged, disturbed, or deteriorating. Information about asbestos is available at the Queensland Government Asbestos Website (asbestos.qld.gov.au) including common locations of asbestos and other practical guidance for homeowners.		

Part 5 – Rates and services

WARNING TO BUYER – The amount of charges imposed on you may be different to the amount imposed on the seller.

Rates

Whichever of the following applies—

The total amount payable* for all rates and charges (without any discount) for the property as stated in the most recent rate notice is:

Amount: Date Range:

OR

The property is currently a rates exempt lot.**

OR

The property is not rates exempt but no separate assessment of rates is issued by a local government for the property.

*Concessions: A local government may grant a concession for rates. The concession will not pass to you as buyer unless you meet the criteria in section 120 of the *Local Government Regulation 2012* or section 112 of the *City of Brisbane Regulation 2012*.

** An exemption for rates applies to particular entities. The exemption will not pass to you as buyer unless you meet the criteria in section 93 of the *Local Government Act 2009* or section 95 of the *City of Brisbane Act 2010*.

Water

Whichever of the following applies—

The total amount payable as charges for water services for the property as indicated in the most recent water services notice* is:

Amount: Date Range:

OR

There is no separate water services notice issued for the lot; however, an estimate of the total amount payable for water services is:

Amount: Date Range:

* A water services notices means a notice of water charges issued by a water service provider under the *Water Supply (Safety and Reliability) Act 2008*.

Part 6 – Community titles schemes and BUGTA schemes

(If the property is part of a community titles scheme or a BUGTA scheme this Part must be completed)

WARNING TO BUYER – If the property is part of a community titles scheme or a BUGTA scheme and you purchase the property, you will become a member of the body corporate for the scheme with the right to participate in significant decisions about the scheme and you will be required to pay contributions towards the body corporate’s expenses in managing the scheme. You will also be required to comply with the by-laws. By-laws will regulate your use of common property and the lot.

For more information about living in a body corporate and your rights and obligations, contact the Office of the Commissioner for Body Corporate and Community Management.

Body Corporate and Community Management Act 1997 The property is included in a community titles scheme. Yes No
(If Yes, complete the information below)

Community Management Statement A copy of the most recent community management statement for the scheme as recorded under the *Land Title Act 1994* or another Act is given to the buyer. Yes

Note—If the property is part of a community titles scheme, the community management statement for the scheme contains important information about the rights and obligations of owners of lots in the scheme including matters such as lot entitlements, by-laws and exclusive use areas.

Body Corporate Certificate A copy of a body corporate certificate for the lot under the *Body Corporate and Community Management Act 1997*, section 205(4) is given to the buyer. Yes No

If No— An explanatory statement is given to the buyer that states: Yes

- » a copy of a body corporate certificate for the lot is not attached; and
- » the reasons under section 6 of the *Property Law Regulation 2024* why the seller has not been able to obtain a copy of the body corporate certificate for the lot.

Statutory Warranties **Statutory Warranties**—If you enter into a contract, you will have implied warranties under the *Body Corporate and Community Management Act 1997* relating to matters such as latent or patent defects in common property or body corporate assets; any actual, expected or contingent financial liabilities that are not part of the normal operating costs; and any circumstances in relation to the affairs of the body corporate that will materially prejudice you as owner of the property. There will be further disclosure about warranties in the contract.

Building Units and Group Titles Act 1980 The property is included in a BUGTA scheme Yes No
(If Yes, complete the information below)

Body Corporate Certificate A copy of a body corporate certificate for the lot under the *Building Units and Group Titles Act 1980*, section 40AA(1) is given to the buyer. Yes No

If No— An explanatory statement is given to the buyer that states: Yes

- » a copy of a body corporate certificate for the lot is not attached; and
- » the reasons under section 7 of the *Property Law Regulation 2024* why the seller has not been able to obtain a copy of the body corporate certificate for the lot.

Note—If the property is part of a BUGTA scheme, you will be subject to by-laws approved by the body corporate and other by-laws that regulate your use of the property and common property.

Signatures – SELLER



Signature of seller

SAMUEL WILLIAM TRACY

Name of seller

2013/26

Date



Signature of seller

AMBER JADE LINGWOOD

Name of seller

2013/26

Date

Signatures – BUYER

By signing this disclosure statement the buyer acknowledges receipt of this disclosure statement before entering into a contract with the seller for the sale of the lot.

Signature of buyer

Name of buyer

Date

Signature of buyer

Name of buyer

Date

Queensland Titles Registry Pty Ltd
ABN 23 648 568 101

Title Reference:	15226066	Search Date:	05/03/2026 08:58
Date Title Created:	07/08/1974	Request No:	55289477
Previous Title:	14242157		

ESTATE AND LAND

Estate in Fee Simple

LOT 10 REGISTERED PLAN 141702
Local Government: LOGAN

REGISTERED OWNER

Dealing No: 716638627 21/07/2015

SAMUEL WILLIAM TRACY
AMBER JADE LINGWOOD

JOINT TENANTS

EASEMENTS, ENCUMBRANCES AND INTERESTS

1. Rights and interests reserved to the Crown by
Deed of Grant No. 10835118 (POR 132)
2. MORTGAGE No 716638628 21/07/2015 at 10:29
COMMONWEALTH BANK OF AUSTRALIA A.B.N. 48 123 123 124

ADMINISTRATIVE ADVICES

NIL

UNREGISTERED DEALINGS

NIL

Caution - Charges do not necessarily appear in order of priority

** End of Current Title Search **

This plan MUST NOT BE FOLDED but may be rolled.

Total Area New Rd. = 7753 m²

141702

141702

Drawing of Plan must be restricted to the space inside the blue lines

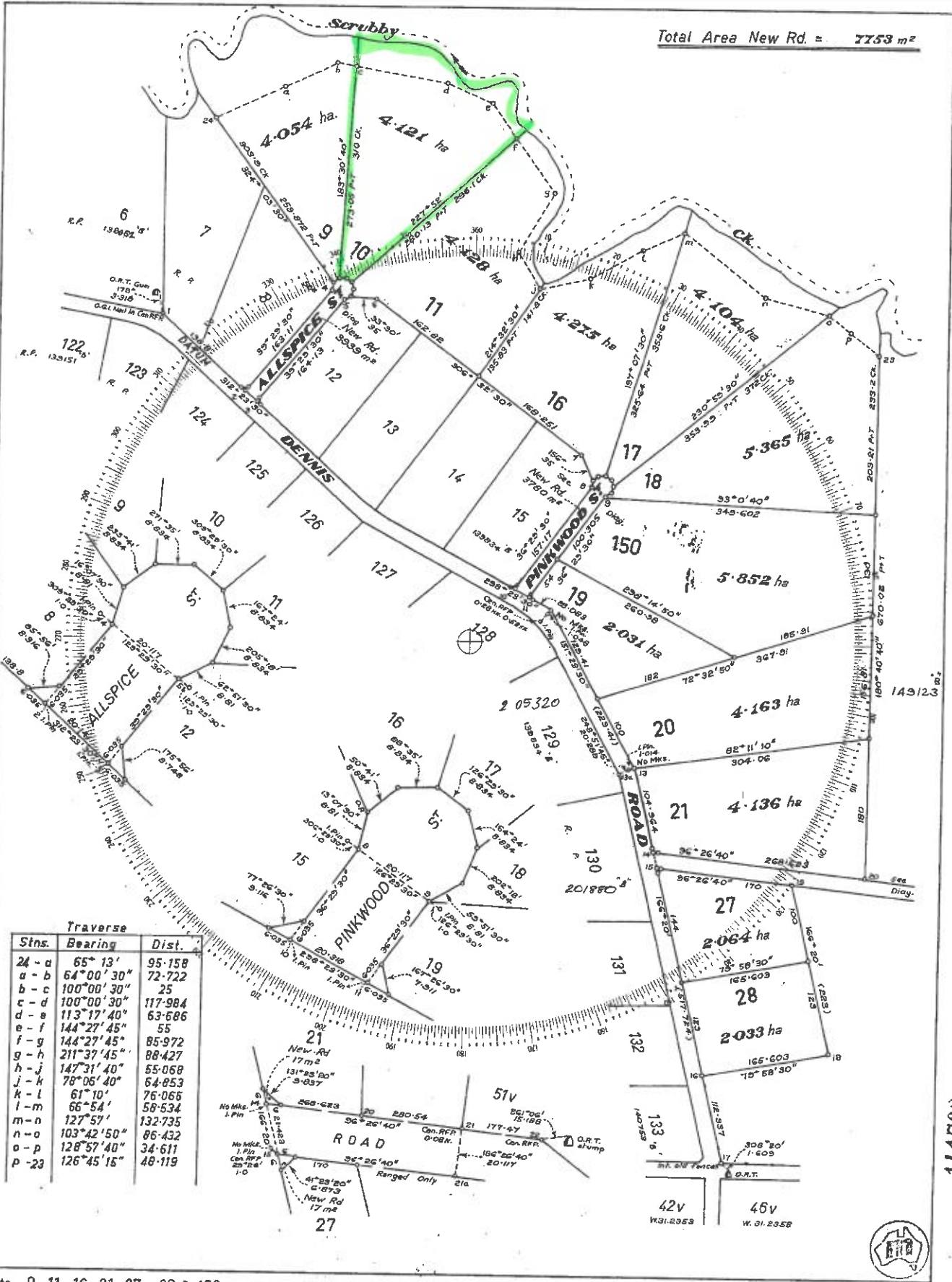

Traverse		
Sns.	Bearing	Dist.
24-a	65° 13'	95.158
a-b	64° 00' 30"	72.722
b-c	100° 00' 30"	25
c-d	100° 00' 30"	117.984
d-e	113° 17' 40"	63.686
e-f	144° 27' 45"	55
f-g	144° 27' 45"	85.972
g-h	211° 37' 45"	88.427
h-j	147° 31' 40"	55.069
j-k	78° 06' 40"	64.853
k-l	61° 10'	76.066
l-m	66° 54'	56.534
m-n	127° 57'	132.735
n-o	103° 42' 50"	86.432
o-p	128° 57' 40"	34.611
p-23	126° 45' 15"	48.119

141702

141702

Lots 9-11, 16-21, 27, 28 & 150
 Orig. Portion 132
 Orig. Grant 78108
 Cancellling part of Subs 1 & 3 on RP 25823
 Town of County of Ward
 Parish of LOGAN
 Surveyed by J. T. Bowers 18/9/1973
 REGISTERED PLAN 141702
 SCALE 1:4000
 CROWN COPYRIGHT RESERVED REGISTRAR OF TITLES, QUEENSLAND
 DIMENSIONS IN METRES
 CISP

This plan MUST NOT BE FOLDED but may be rolled.

No 30802

John Thomas Bowers Brisbane
 Authorized Surveyor, do hereby solemnly and sincerely declare that I have faithfully and truly surveyed, measured and marked on the ground the parcel of land herein referred to, and that the measurements and boundaries given in this plan are correct, and do not to the best of my belief in any way interfere with the rights or property of any persons, owners or occupiers of the land adjoining the above land, and described in the said plan; and I make this solemn declaration conscientiously believing the same to be true, and by virtue of the provisions of the Statute Act, 1867-1960"

John T. Bowers
 Authorized Surveyor

Made and Signed at Brisbane this 18th day of Sept 1973 before me.

Signature of Registrar of Titles or of a Magistrate.

- FOR SURVEYOR'S USE ONLY -
 SURVEY OF LOTS 9-11, 16-21, 27, 28 & 150

County of Ward Parish of LOGAN

Town of _____ To the Depth of _____
 Cancelling part of Subs 1 & 3 on RP 25823

Orig. Grant 7810A Orig. Portion 132

The Council of the SHIRE of BEAUDESERT certifies that all the requirements of this Council, the Local Government Acts of 1936 to 1972 and all By-Laws have been complied with and approves this Plan of Subdivision subject to _____

Dated this 21st day of January 1974

Andrew O'Connell Chairman
Malcolm Mayor
 Town or Shire Clerk

- FOR OFFICE USE ONLY -
 Previous Title C.T. 3552-52, Pts 157, 158, 159, 160, 161, 162, 163, 164, 165, 166, 167, 168, 169, 170, 171, 172, 173, 174, 175, 176, 177, 178, 179, 180, 181, 182, 183, 184, 185, 186, 187, 188, 189, 190, 191, 192, 193, 194, 195, 196, 197, 198, 199, 200, 201, 202, 203, 204, 205, 206, 207, 208, 209, 210, 211, 212, 213, 214, 215, 216, 217, 218, 219, 220, 221, 222, 223, 224, 225, 226, 227, 228, 229, 230, 231, 232, 233, 234, 235, 236, 237, 238, 239, 240, 241, 242, 243, 244, 245, 246, 247, 248, 249, 250, 251, 252, 253, 254, 255, 256, 257, 258, 259, 260, 261, 262, 263, 264, 265, 266, 267, 268, 269, 270, 271, 272, 273, 274, 275, 276, 277, 278, 279, 280, 281, 282, 283, 284, 285, 286, 287, 288, 289, 290, 291, 292, 293, 294, 295, 296, 297, 298, 299, 300, 301, 302, 303, 304, 305, 306, 307, 308, 309, 310, 311, 312, 313, 314, 315, 316, 317, 318, 319, 320, 321, 322, 323, 324, 325, 326, 327, 328, 329, 330, 331, 332, 333, 334, 335, 336, 337, 338, 339, 340, 341, 342, 343, 344, 345, 346, 347, 348, 349, 350, 351, 352, 353, 354, 355, 356, 357, 358, 359, 360, 361, 362, 363, 364, 365, 366, 367, 368, 369, 370, 371, 372, 373, 374, 375, 376, 377, 378, 379, 380, 381, 382, 383, 384, 385, 386, 387, 388, 389, 390, 391, 392, 393, 394, 395, 396, 397, 398, 399, 400, 401, 402, 403, 404, 405, 406, 407, 408, 409, 410, 411, 412, 413, 414, 415, 416, 417, 418, 419, 420, 421, 422, 423, 424, 425, 426, 427, 428, 429, 430, 431, 432, 433, 434, 435, 436, 437, 438, 439, 440, 441, 442, 443, 444, 445, 446, 447, 448, 449, 450, 451, 452, 453, 454, 455, 456, 457, 458, 459, 460, 461, 462, 463, 464, 465, 466, 467, 468, 469, 470, 471, 472, 473, 474, 475, 476, 477, 478, 479, 480, 481, 482, 483, 484, 485, 486, 487, 488, 489, 490, 491, 492, 493, 494, 495, 496, 497, 498, 499, 500, 501, 502, 503, 504, 505, 506, 507, 508, 509, 510, 511, 512, 513, 514, 515, 516, 517, 518, 519, 520, 521, 522, 523, 524, 525, 526, 527, 528, 529, 530, 531, 532, 533, 534, 535, 536, 537, 538, 539, 540, 541, 542, 543, 544, 545, 546, 547, 548, 549, 550, 551, 552, 553, 554, 555, 556, 557, 558, 559, 560, 561, 562, 563, 564, 565, 566, 567, 568, 569, 570, 571, 572, 573, 574, 575, 576, 577, 578, 579, 580, 581, 582, 583, 584, 585, 586, 587, 588, 589, 590, 591, 592, 593, 594, 595, 596, 597, 598, 599, 600, 601, 602, 603, 604, 605, 606, 607, 608, 609, 610, 611, 612, 613, 614, 615, 616, 617, 618, 619, 620, 621, 622, 623, 624, 625, 626, 627, 628, 629, 630, 631, 632, 633, 634, 635, 636, 637, 638, 639, 640, 641, 642, 643, 644, 645, 646, 647, 648, 649, 650, 651, 652, 653, 654, 655, 656, 657, 658, 659, 660, 661, 662, 663, 664, 665, 666, 667, 668, 669, 670, 671, 672, 673, 674, 675, 676, 677, 678, 679, 680, 681, 682, 683, 684, 685, 686, 687, 688, 689, 690, 691, 692, 693, 694, 695, 696, 697, 698, 699, 700, 701, 702, 703, 704, 705, 706, 707, 708, 709, 710, 711, 712, 713, 714, 715, 716, 717, 718, 719, 720, 721, 722, 723, 724, 725, 726, 727, 728, 729, 730, 731, 732, 733, 734, 735, 736, 737, 738, 739, 740, 741, 742, 743, 744, 745, 746, 747, 748, 749, 750, 751, 752, 753, 754, 755, 756, 757, 758, 759, 760, 761, 762, 763, 764, 765, 766, 767, 768, 769, 770, 771, 772, 773, 774, 775, 776, 777, 778, 779, 780, 781, 782, 783, 784, 785, 786, 787, 788, 789, 790, 791, 792, 793, 794, 795, 796, 797, 798, 799, 800, 801, 802, 803, 804, 805, 806, 807, 808, 809, 810, 811, 812, 813, 814, 815, 816, 817, 818, 819, 820, 821, 822, 823, 824, 825, 826, 827, 828, 829, 830, 831, 832, 833, 834, 835, 836, 837, 838, 839, 840, 841, 842, 843, 844, 845, 846, 847, 848, 849, 850, 851, 852, 853, 854, 855, 856, 857, 858, 859, 860, 861, 862, 863, 864, 865, 866, 867, 868, 869, 870, 871, 872, 873, 874, 875, 876, 877, 878, 879, 880, 881, 882, 883, 884, 885, 886, 887, 888, 889, 890, 891, 892, 893, 894, 895, 896, 897, 898, 899, 900, 901, 902, 903, 904, 905, 906, 907, 908, 909, 910, 911, 912, 913, 914, 915, 916, 917, 918, 919, 920, 921, 922, 923, 924, 925, 926, 927, 928, 929, 930, 931, 932, 933, 934, 935, 936, 937, 938, 939, 940, 941, 942, 943, 944, 945, 946, 947, 948, 949, 950, 951, 952, 953, 954, 955, 956, 957, 958, 959, 960, 961, 962, 963, 964, 965, 966, 967, 968, 969, 970, 971, 972, 973, 974, 975, 976, 977, 978, 979, 980, 981, 982, 983, 984, 985, 986, 987, 988, 989, 990, 991, 992, 993, 994, 995, 996, 997, 998, 999, 1000

Mortgagee's consent to dedication of new road given.

For Additional Plan & Document Notings Refer to CISP

I/We MATTHEWS & JOHNSON SUBDIVISIONS PTY. LTD. as proprietor/s of this land, agree to this Plan of subdivision, and dedicate the new roads shown hereon to public use.

Signature of Proprietor/s: MATTHEWS & JOHNSON SUBDIVISIONS PTY. LTD. BY ITS ATTORNEY - JAMES FRANCIS FITZGERALD:

J.F. Fitzgerald

2nd of title by 15/11
4242-157 lodge addition 13/1/74
3552-52 correct

C.T.	Lots	New Ref.
3552-52	27828	17/11/74
4242-157	9-11, 16-21, 150	7736

New C.T. Ref.

(Re) Sub.	Vol.	Inch.
1	3226	45
2		45
3		45
4		45
5		45
6		45
7		45
8		45
9		45
10		45
11		45
12		45
13		45
14		45
15		45
16		45
17		45
18		45
19		45
20		45
21		45
22		45
23		45
24		45
25		45
26		45
27		45
28		45
29		45
30		45
31		45
32		45
33		45
34		45
35		45
36		45
37		45
38		45
39		45
40		45
41		45
42		45
43		45
44		45
45		45
46		45
47		45
48		45
49		45
50		45
51		45
52		45
53		45
54		45
55		45
56		45
57		45
58		45
59		45
60		45
61		45
62		45
63		45
64		45
65		45
66		45
67		45
68		45
69		45
70		45
71		45
72		45
73		45
74		45
75		45
76		45
77		45
78		45
79		45
80		45
81		45
82		45
83		45
84		45
85		45
86		45
87		45
88		45
89		45
90		45
91		45
92		45
93		45
94		45
95		45
96		45
97		45
98		45
99		45
100		45

25-00 4 x 8
6-00
84-00 MT
3-00
3-00 A
3-00
3-00 PH
12-00
129-00
66454

2/1/73

F717960

NEW TITLES
 Vol. _____
 REF. _____
 11 4 40 PM '74

Locate for title to consent should be found in

Calc. Bk. No. 201/57
 Examined 26/11/74
 Passed 26/11/74
 Charred 1/12/73
 Located 1/12/73
Logan, PLA

Particulars entered in Register Book
 Vol. 201/57 Folio 52
1042 157
 the 2 day of JUL 1974 at 200

James Fitzgerald
 REGISTRAR OF TITLES

Lodged by: **Walsh, FitzGerald & Hilton**
 SOLICITORS
 QUEEN STREET, BRISBANE

REGISTERED PLAN **141702**

141702

A pool safety certificate is required in Queensland when selling or leasing a property with a regulated pool. This form is to be used for the purposes of sections 246AA and 246AK of the *Building Act 1975*.

1. Pool safety certificate number

Identification number: PSC0246660

2. Location of the swimming pool

Property details are usually shown on the title documents and rates notices

Street address: 20 ALLSPICE ST

CEDAR VALE QLD

Postcode 4 2 8 5

Lot and plan details: 10/RP/141702

Local government area: LOGAN CITY

3. Exemptions or alternative solutions for the swimming pool (if applicable)

If an exemption or alternative solution is applicable to the swimming pool please state this. This will help provide pool owners with a concise and practical explanation of the exemption or alternative solution. It will also help to ensure the ongoing use of the pool and any future modifications do not compromise compliance with the pool safety standard.

No disability exemption applies; No impracticality exemption applies

No alternative solution applies

4. Pool properties

Shared pool

Non-shared pool

Number of pools 1

5. Pool safety certificate validity

Effective date: 2 4 / 0 3 / 2 0 2 5

Expiry date: 2 4 / 0 3 / 2 0 2 7

6. Certification

I certify that I have inspected the swimming pool and I am reasonably satisfied that, under the *Building Act 1975*, the pool is a complying pool.

Name: Kara-Marie Bruce

Pool safety inspector licence number: PS15324357

Signature:

Other important information that could help save a young child's life

It is the pool owner's responsibility to ensure that the pool (including the barriers for the pool) is properly maintained at all times to comply with the pool safety standard under the *Building Act 1975*. High penalties apply for non-compliance. Parents should also consider beginning swimming lessons for their young children from an early age. Please visit <https://www.qbcc.qld.gov.au/your-property/swimming-pools/pool-safety-standard> for further information about swimming pool safety. This pool safety certificate does not certify that a building development approval has been given for the pool or the barriers for the pool. You can contact your local government to ensure this approval is in place.

Privacy statement

The Queensland Building and Construction Commission is collecting personal information as required under the *Building Act 1975*. This information may be stored by the QBCC, and will be used for administration, compliance, statistical research and evaluation of pool safety laws. Your personal information will be disclosed to other government agencies, local government authorities and third parties for purposes relating to administering and monitoring compliance with the *Building Act 1975*. Personal information will otherwise only be disclosed to third parties with your consent or unless authorised or required by law.

RTI: The information collected on this form will be retained as required by the *Public Records Act 2002* and other relevant Acts and regulations, and is subject to the Right to Information regime established by the *Right to Information Act 2009*.

This is a public document and the information in this form will be made available to the public.

Contact Details

Contact Rose McIlvrade Email rose@rmolaw.com.au	Contact number (07) 5540 3940	Company RMO Law Address Cusack Lane Jimboomba Qld 4280	Enquirer ID 3729557
---	---	--	-------------------------------

Job Site and Enquiry Details

WARNING: The map below only displays the location of the proposed job site and does not display any asset owners' pipe or cables. The area highlighted has been used only to identify the participating asset owners, who will send information to you directly.

Enquiry date 11/03/2026	Start date 11/03/2026	End date 30/04/2026	On behalf of Private	Job purpose Design	Locations Both Road, Nature Strip, Footpath	Onsite activities Conveyancing
-----------------------------------	---------------------------------	-------------------------------	--------------------------------	------------------------------	--	--



Check that the location of the job site is correct. If not, you must submit a new enquiry.

If the scope of works change or plan validity dates expire, you must submit a new enquiry.

Do NOT dig without plans. Safe excavation is your responsibility. If you don't understand the plans or how to proceed safely, please contact the relevant asset owners.

User Reference 20 Allspice St	Address 20 Allspice St Cedar Vale QLD 4285	Notes/description -
---	---	-------------------------------

Your Responsibility and Duty of Care

- **Lodging an enquiry does not authorise project commencement.** Before starting work, you must obtain all necessary information from all affected asset owners.
- If you don't receive plans within 2 business days, contact the asset owner & quote their sequence number.
- Always follow the 5Ps of Safe Excavation (page 2), and locate assets before commencing work.
- Ensure you comply with State legislative requirements for Duty of Care and safe digging.
- If you damage an underground asset, you MUST advise the asset owner immediately.
- By using the BYDA service, you agree to the Privacy Policy and Term of Use.
- For more information on safe digging practices, visit www.byda.com.au

Asset Owner Details

Below is a list of asset owners with underground infrastructure in and around your job site. It is your responsibility to identify the presence of these assets. Plans issued by Members are indicative only unless specified otherwise. Note: not all asset owners are registered with BYDA. You must contact asset owners not listed here directly.

Referral ID (Seq. no)	Authority Name	Phone	Status
269558358	Logan City Council	(07) 3412 3412	NOTIFIED
269558357	NBN Co Qld	1800 687 626	NOTIFIED
269558360	Telstra QLD FA	1800 653 935	NOTIFIED
269558359	Telstra QLD Regional	1800 653 935	NOTIFIED

END OF UTILITIES LIST

The 5Ps of Safe Excavation



Plan

Plan your job. Use the BYDA service at least one day before your job is due to begin, and ensure you have the correct plans and information required to carry out a safe project.



Prepare

Prepare by communicating with asset owners if you need assistance. Look for clues onsite. Engage a skilled Locator.



Pothole

Potholing is physically sighting the asset by hand digging or hydro vacuum extraction.

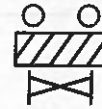

Protect

Protecting and supporting the exposed infrastructure is the responsibility of the excavator. Always erect safety barriers in areas of risk and enforce exclusion zones.



Proceed

Only proceed with your excavation work after planning, preparing, potholing (unless prohibited), and having protective measures in place.

Engage a skilled Locator

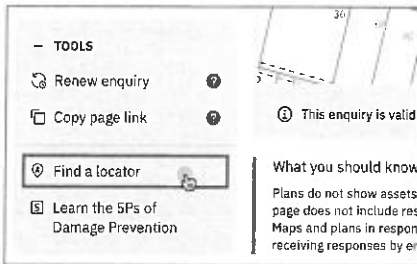

When you lodge an enquiry you will see skilled Locators to contact

Visit the Certified Locator website directly and search for a locator near you
certloc.com.au/locators

Get FREE Quotes for Contractors & Equipment Fast



Use iseekplant's FREE marketplace to get quotes for the equipment or services you need on your project. Compare quotes from trusted local contractors and get your project done on time and in budget.

1. Fill out your job details in our FREE quick quote form.
2. We send the request to trusted local contractors.
3. The local contractors will contact you directly with quotes

GET QUOTE

Use iseekplant to find trusted contractors near you today, visit:
blog.iseekplant.com.au/byda-isp-get-quotes

Book a FREE BYDA Session



BYDA offers free training sessions to suit you and your organisation's needs covering safe work practices when working near essential infrastructure assets. The free sessions are offered in two different formats - online and face-to-face.

To book a session, visit:
byda.com.au/contact/education-awareness-enquiry-form

BOOK NOW

To: Rose McIlvride
Phone: Not Supplied
Fax: Not Supplied
Email: rose@rmolaw.com.au

Before You Dig Australia Job #:	52594789	 BEFORE YOU DIG www.byda.com.au Zero Damage - Zero Harm
Sequence #	269558357	
Issue Date:	11/03/2026	
Location:	20 Allspice St , Cedar Vale , QLD , 4285	

Information

The area of interest requested by you contains one or more assets.

nbn™ Assets	Search Results
Communications	Asset identified
Electricity	No assets

In this notice **nbn™ Facilities** means *underground fibre optic, telecommunications and/or power facilities, including but not limited to cables, owned and controlled by nbn™*

Location of **nbn™** Underground Assets

We thank you for your enquiry. In relation to your enquiry at the above address:

- **nbn's** records indicate that there **ARE nbn™** Facilities in the vicinity of the location identified above ("Location").
- **nbn** indicative plan/s are attached with this notice ("Indicative Plans").
- The Indicative Plan/s show general depth and alignment information only and are not an exact, scale or accurate depiction of the location, depth and alignment of **nbn™** Facilities shown on the Plan/s.
- In particular, the fact that the Indicative Plans show that a facility is installed in a straight line, or at uniform depth along its length cannot be relied upon as evidence that the facility is, in fact, installed in a straight line or at uniform depth.
- You should read the Indicative Plans in conjunction with this notice and in particular, the notes below.
- You should note that, at the present time, the Indicative Plans are likely to be more accurate in showing location of fibre optics and telecommunications cables than power cables. There may be a variation between the line depicted on the Indicative Plans and the location of any power cables. As such, consistent with the notes below, particular care must be taken by you to make your own enquiries and investigations to precisely locate any power cables and manage the risk arising from such cables accordingly.
- The information contained in the Indicative Plan/s is valid for 28 days from the date of issue set out above. You are expected to make your own inquiries and perform your own investigations (including engaging appropriately qualified plant locators, e.g BYDA Certified Locators, at your cost to locate **nbn™** Facilities during any activities you carry out on site).

We thank you for your enquiry and appreciate your continued use of the Before You Dig Australia Service. For any enquiries related to moving assets or Planning and Design activities, please visit the **nbn Commercial Works** website to complete the online application form. If you are planning to excavate and require further information, please email dbyd@nbnco.com.au or call 1800 626 329.

Notes:

1. You are now aware that there are **nbn™** Facilities in the vicinity of the above property that could be damaged as a result activities carried out (or proposed to be carried out) by you in the vicinity of the Location.
2. You should have regard to section 474.6 and 474.7 of the *Criminal Code Act 1995* (CoA) which deals with the consequences of interfering or tampering with a telecommunications facility. Only persons authorised by **nbn** can interact with **nbn's** network facilities.
3. Any information provided is valid only for **28 days** from the date of issue set out above.

Referral Conditions

The following are conditions on which **nbn** provides you with the Indicative Plans. By accepting the plans, you are agreeing to these conditions. These conditions are in addition, and not in replacement of, any duties and obligations you have under applicable law.

1. **nbn** does not accept any responsibility for any inaccuracies of its plans including the Indicative Plans. You are expected to make your own inquiries and perform your own investigations (including engaging appropriately qualified plant locators, e.g BYDA Certified Locators, at your cost to locate **nbn™** Facilities during any activities you carry out on site).
2. You acknowledge that **nbn** has specifically notified you above that the Indicative Plans are likely to be more accurate in showing location of fibre optics and telecommunications cables than power cables. There may be a variation between the line depicted on the Indicative Plans and the location of any power cables.
3. You should not assume that **nbn™** Facilities follow straight lines or are installed at uniformed depths

along their lengths, even if they are indicated on plans provided to you. Careful onsite investigations are essential to locate the exact position of cables.

4. In carrying out any works in the vicinity of **nbn**™ Facilities, you must maintain the following minimum clearances:
 - 300mm when laying assets inline, horizontally or vertically.
 - 500mm when operating vibrating equipment, for example: jackhammers or vibrating plates.
 - 1000mm when operating mechanical excavators.
 - Adherence to clearances as directed by other asset owner's instructions and take into account any uncertainty for power cables.
5. You are aware that there are inherent risks and dangers associated with carrying out work in the vicinity of underground facilities (such as **nbn**™ fibre optic, copper and coaxial cables, and power cable feed to **nbn**™ assets). Damage to underground electric cables may result in:
 - Injury from electric shock or severe burns, with the possibility of death.
 - Interruption of the electricity supply to wide areas of the city.
 - Damage to your excavating plant.
 - Responsibility for the cost of repairs.
6. You must take all reasonable precautions to avoid damaging **nbn**™ Facilities. These precautions may include but not limited to the following:
 - All excavation sites should be examined for underground cables by careful hand excavation. Cable cover slabs if present must not be disturbed. Hand excavation needs to be undertaken with extreme care to minimise the likelihood of damage to the cable, for example: the blades of hand equipment should be aligned parallel to the line of the cable rather than digging across the cable.
 - If any undisclosed underground cables are located, notify **nbn** immediately.
 - All personnel must be properly briefed, particularly those associated with the use of earth-moving equipment, trenching, boring and pneumatic equipment.
 - The safety of the public and other workers must be ensured.
 - All excavations must be undertaken in accordance with all relevant legislation and regulations.
7. You will be responsible for all damage to **nbn**™ Facilities that are connected whether directly, or indirectly with work you carry out (or work that is carried out for you or on your behalf) at the Location. This will include, without limitation, all losses expenses incurred by **nbn** as a result of any such damage.
8. You must immediately report any damage to the **nbn**™ network that you are/become aware of. Notification may be by telephone - 1800 626 329.
9. Except to the extent that liability may not be capable of lawful exclusion, **nbn** and its servants and agents and the related bodies corporate of **nbn** and their servants and agents shall be under no liability whatsoever to any person for any loss or damage (including indirect or consequential loss or damage) however caused (including, without limitation, breach of contract negligence and/or breach of statute) which may be suffered or incurred from or in connection with this information sheet or any plans (including Indicative Plans) attached hereto. Except as expressly provided to the contrary in this information sheet or the attached plans (including Indicative Plans), all terms, conditions, warranties, undertakings or representations (whether expressed or implied) are excluded to the fullest extent permitted by law.

All works undertaken shall be in accordance with all relevant legislations, acts and regulations applicable to the particular state or territory of the Location. The following table lists all relevant documents that shall be considered and adhered to.

State/Territory	Documents
National	Work Health and Safety Act 2011
	Work Health and Safety Regulations 2011
	Safe Work Australia - Working in the Vicinity of Overhead and Underground Electric Lines (Draft)

	Occupational Health and Safety Act 1991
NSW	Electricity Supply Act 1995
	Work Cover NSW - Work Near Underground Assets Guide
	Work Cover NSW - Excavation Work: Code of Practice
VIC	Electricity Safety Act 1998
	Electricity Safety (Network Asset) Regulations 1999
QLD	Electrical Safety Act 2002
	Code of Practice for Working Near Exposed Live Parts
SA	Electricity Act 1996
TAS	Tasmanian Electricity Supply Industry Act 1995
WA	Electricity Act 1945
	Electricity Regulations 1947
NT	Electricity Reform Act 2005
	Electricity Reform (Safety and Technical) Regulations 2005
ACT	Electricity Act 1971

Thank You,

nbn BYDA

Date: 11/03/2026

This document is provided for information purposes only. This document is subject to the information classification set out on this page. If no information classification has been included, this document must be treated as UNCLASSIFIED, SENSITIVE and must not be disclosed other than with the consent of nbn co. The recipient (including third parties) must make and rely on their own inquiries as to the currency, accuracy and completeness of the information contained herein and must not use this document other than with the consent of nbn co.

Copyright © 2021 nbn co Limited. All rights reserved.

To: Rose McIlvride
Phone: Not Supplied
Fax: Not Supplied
Email: rose@rmolaw.com.au

Dial before you dig Job #:	52594789	 BEFORE YOU DIG www.byda.com.au Zero Damage - Zero Harm
Sequence #	269558357	
Issue Date:	11/03/2026	
Location:	20 Allspice St , Cedar Vale , QLD , 4285	



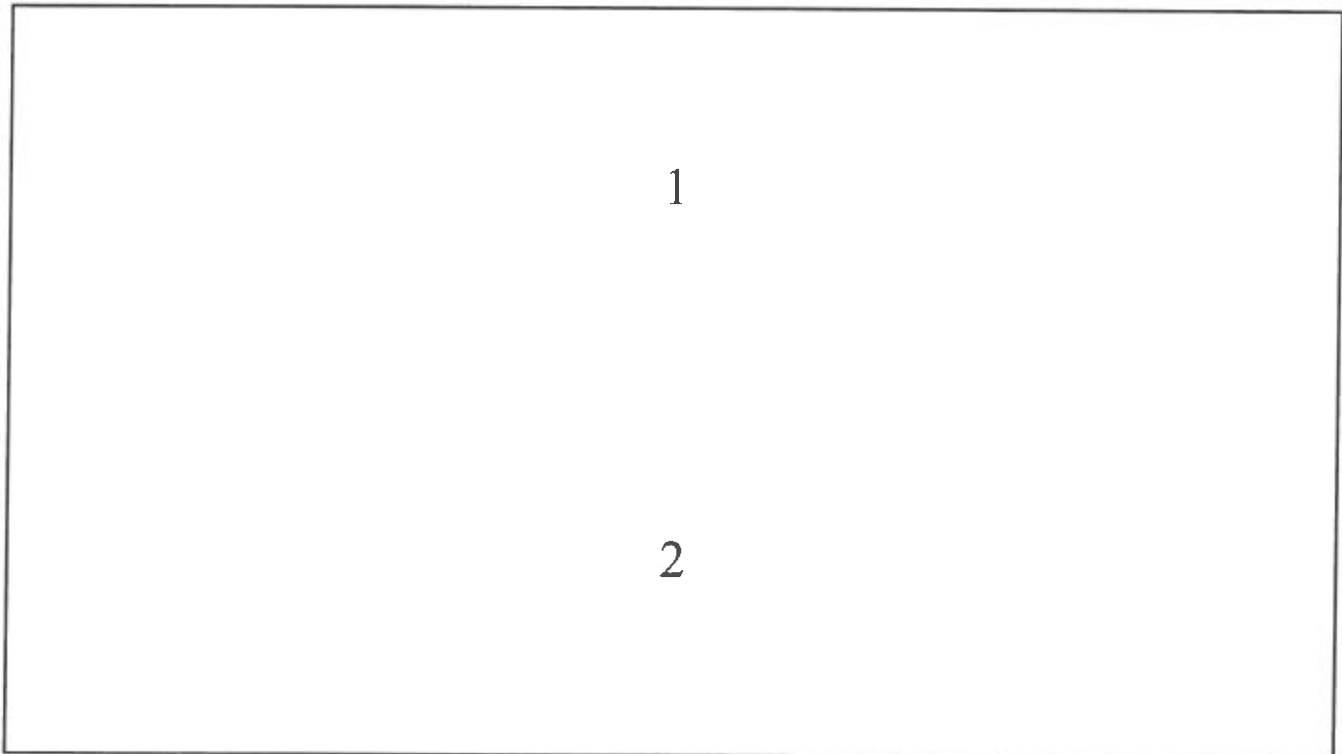

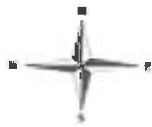



Indicative Plans are tiled below to demonstrate how to layout and read nbn asset plans

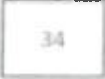

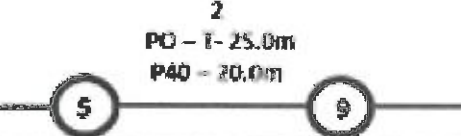
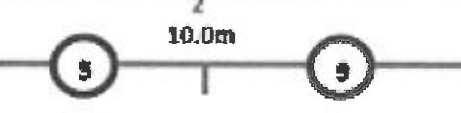

LEGEND

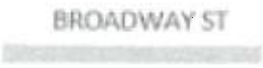
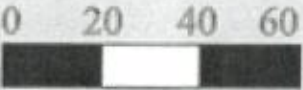

	Parcel and the location
	Pit with size "5"
	Power Pit with size "2E". Valid PIT Size: e.g. 2E, 5E, 6E, 8E, 9E, E, null.
	Manhole
	Pillar
	Cable count of trench is 2. One "Other size" PVC conduit (PO) owned by Telstra (-T-), between pits of sizes, "5" and "9" are 25.0m apart. One 40mm PVC conduit (P40) owned by NBN, between pits of sizes, "5" and "9" are 20.0m apart.
	2 Direct buried cables between pits of sizes, "5" and "9" are 10.0m apart.
	Trench containing any INSERVICE/CONSTRUCTED (Copper/RF/Fibre) cables.
	Trench containing only DESIGNED/PLANNED (Copper/RF/Fibre/Power) cables.
	Trench containing any INSERVICE/CONSTRUCTED (Power) cables.
	Road and the street name "Broadway ST"
<p data-bbox="344 1895 424 1928">Scale</p>	 <p data-bbox="991 1895 1222 2007">Meters 1:2000 1 cm equals 20 m</p>

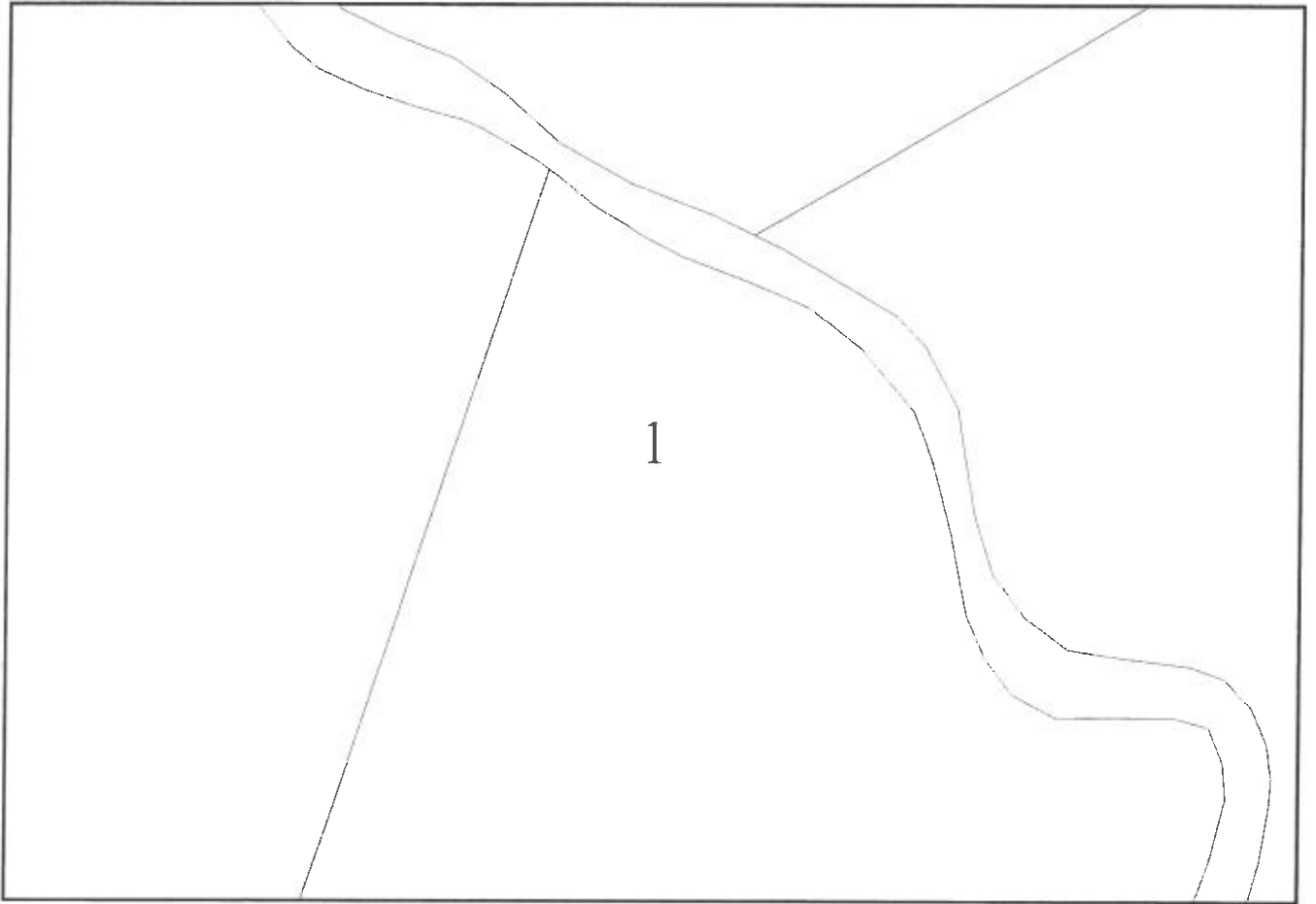

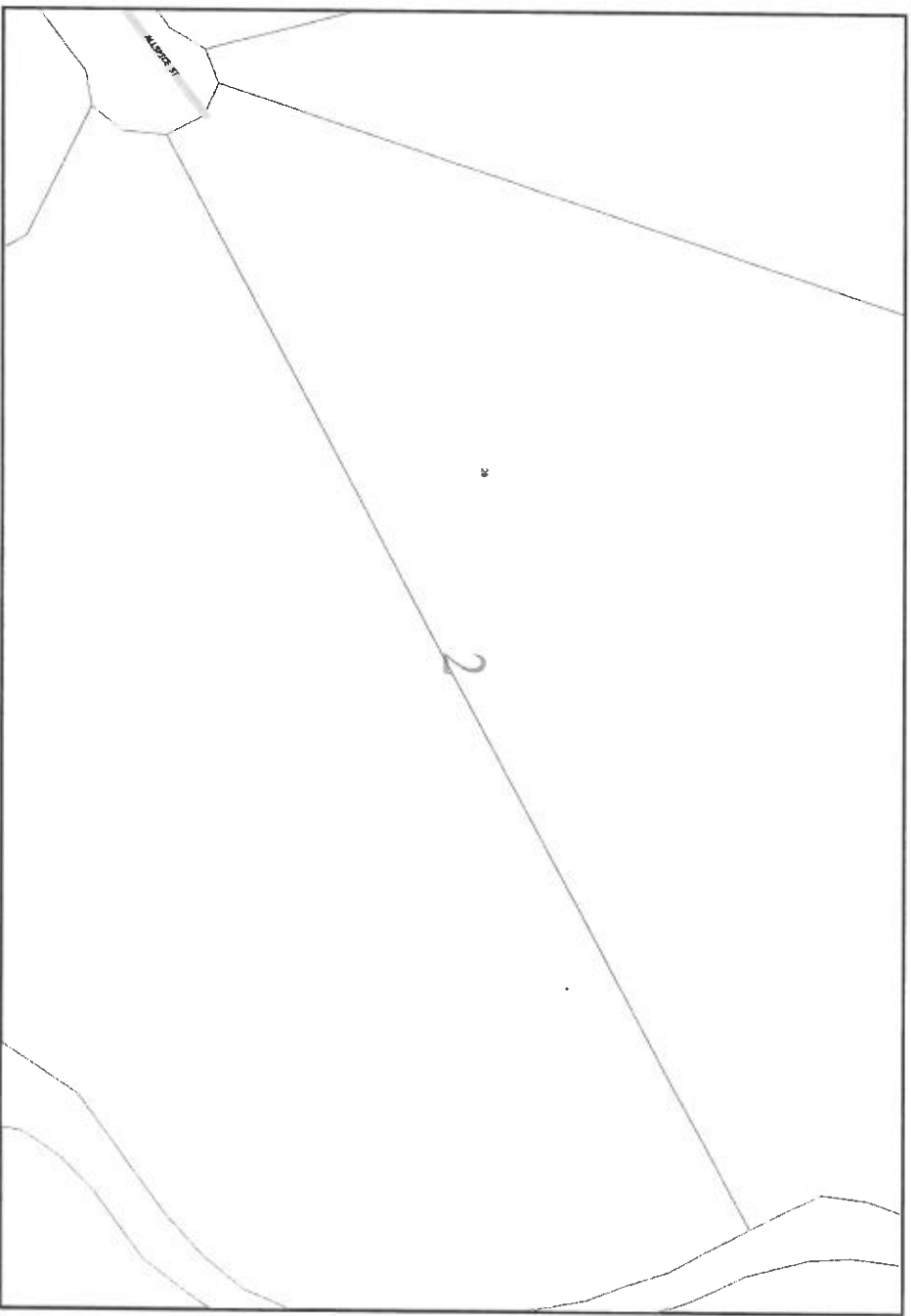

Emergency Contacts

You must immediately report any damage to the **nbn**™ network that you are/become aware of. Notification may be by telephone - 1800 626 329.



Working near nbn™ cables

nbn has partnered with Dial Before You Dig to give you a single point of contact to get information about **nbn** underground services owned by **nbn** and other utility/service providers in your area including communications, electricity, gas and other services. Contact with underground power cables and gas services can result in serious injury to the worker, and damage and costly repairs. You must familiarise yourself with all of the Referral Conditions (meaning the referral conditions referred to in the DBYD Notice provided by **nbn**).

Practice safe work habits

Once the DBYD plans are reviewed, the Five P's of Excavation should be adopted in conjunction with your safe work practices (which must be compliant with the relevant state Electrical Safety Act and Safe Work Australia "Excavation Work Code of Practice", as a minimum) to ensure the risk of any contact with underground **nbn** assets are minimised.



Plan: Plan your job by ensuring the plans received are current and apply to the work to be performed. Also check for any visual cues that may indicate the presence of services not covered in the DBYD plans.



Prepare: Prepare for your job by engaging a DBYD Certified Plant Locator to help interpret plans and identify on-site assets. Contact **nbn** should you require further assistance.



Pothole: Non-destructive potholing (i.e. hand digging or hydro excavation) should be used to positively locate **nbn** underground assets with minimal risk of contact and service damage.

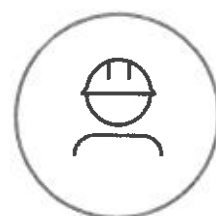

Protect: Protecting and supporting the exposed **nbn** underground asset is the responsibility of the worker. Exclusion zones for **nbn** assets are clearly stated in the plan and appropriate controls must be implemented to ensure that encroachment into the exclusion zone by machinery or activities with the potential to damage the asset is prevented.



Proceed: Proceed only when the appropriate planning, preparation, potholing and protective measures are in place.

Working near **nbn**TM cables

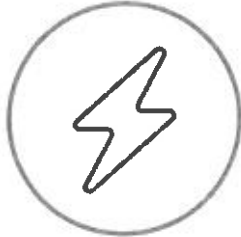

Identify all electrical hazards, assess the risks and establish control measures.



When using excavators and other machinery, also check the location of overhead power lines.

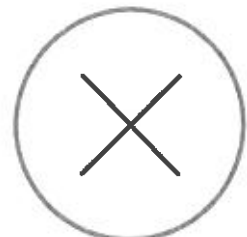

Workers and equipment must maintain safety exclusion zones around power lines.

Once all work is completed, the excavation should be re-instated with the same type of excavated material unless specified by **nbn**. Please note:

- Construction Partners of **nbn** may require additional controls to be in place when performing excavation activities.
- The information contained within this pamphlet must be used in conjunction with other material supplied as part of this request for information to adequately control the risk of potential asset damage.

Contact

All **nbn**TM network facility damages must be reported online [here](#).
For enquiries related to your DBYD request please call 1800 626 329.

Disclaimer

This brochure is a guide only. It does not address all the matters you need to consider when working near our cables. You must familiarise yourself with other material provided (including the Referral Conditions) and make your own inquiries as appropriate.

nbn will not be liable or responsible for any loss, damage or costs incurred as a result of reliance on this brochure.

This document is provided for information purposes only. This document is subject to the information classification set out on this page. If no information classification has been included, this document must be treated as UNCLASSIFIED, SENSITIVE and must not be disclosed other than with the consent of **nbn** co. The recipient (including third parties) must make and rely on their own inquiries as to the currency, accuracy and completeness of the information contained herein and must not use this document other than with the consent of **nbn** co. Copyright © 2021 **nbn** co limited. All rights reserved.



Before You Dig Australia (BYDA)

Asset Location Response



PO Box 3226 Logan City DC QLD 4114 • 150 Wembley Road, Logan Central
p (07) 3412 3412 • e council@logan.qld.gov.au • www.logan.qld.qov.au • ABN 21-627-796 435

RMO Law - Rose McIlvride
Cusack Lane
Jimboomba Qld 4280
rose@rmolaw.com.au

Logan City Council has been advised that you have placed an enquiry through the Before You Dig Australia service with the following details. Logan City Council confirms that the proposed work(s) will not impact any of their assets in the reference area of your request.

Enquiry Details	
Sequence Number	269558358
Enquiry Date	11/03/2026 12:39
Response	NOT AFFECTED
Address	20 Allspice St Cedar Vale
Location in Road	Road,Nature Strip,Footpath
Activity	Conveyancing

Maps have been enclosed with your requested area highlighted to assist in identifying the location of Logan City Council Assets.

For any enquiries relating to this please contact Road Infrastructure Planning on (07) 3412 5282.

Disclaimer: This document is confidential to the addressee and may also be privileged, and neither confidentiality nor privilege is waived, lost or destroyed by virtue of it being transmitted to an incorrect addressee. Unauthorised use of the contents is therefore strictly prohibited. Any information contained in this document that has been extracted from Council's records is believed to be accurate, but no responsibility is assumed for any error or omission. Council will only accept responsibility for information contained under official letterhead and duly signed by, or on behalf of, Chief Executive Officer.

Logan City Council's infrastructure dates back over many years and may include manufactured materials containing asbestos. You are solely responsible for ensuring that appropriate care is taken at all times and that you comply with all mandatory requirements relating to such matters, including but not limited to "workplace health and safety".

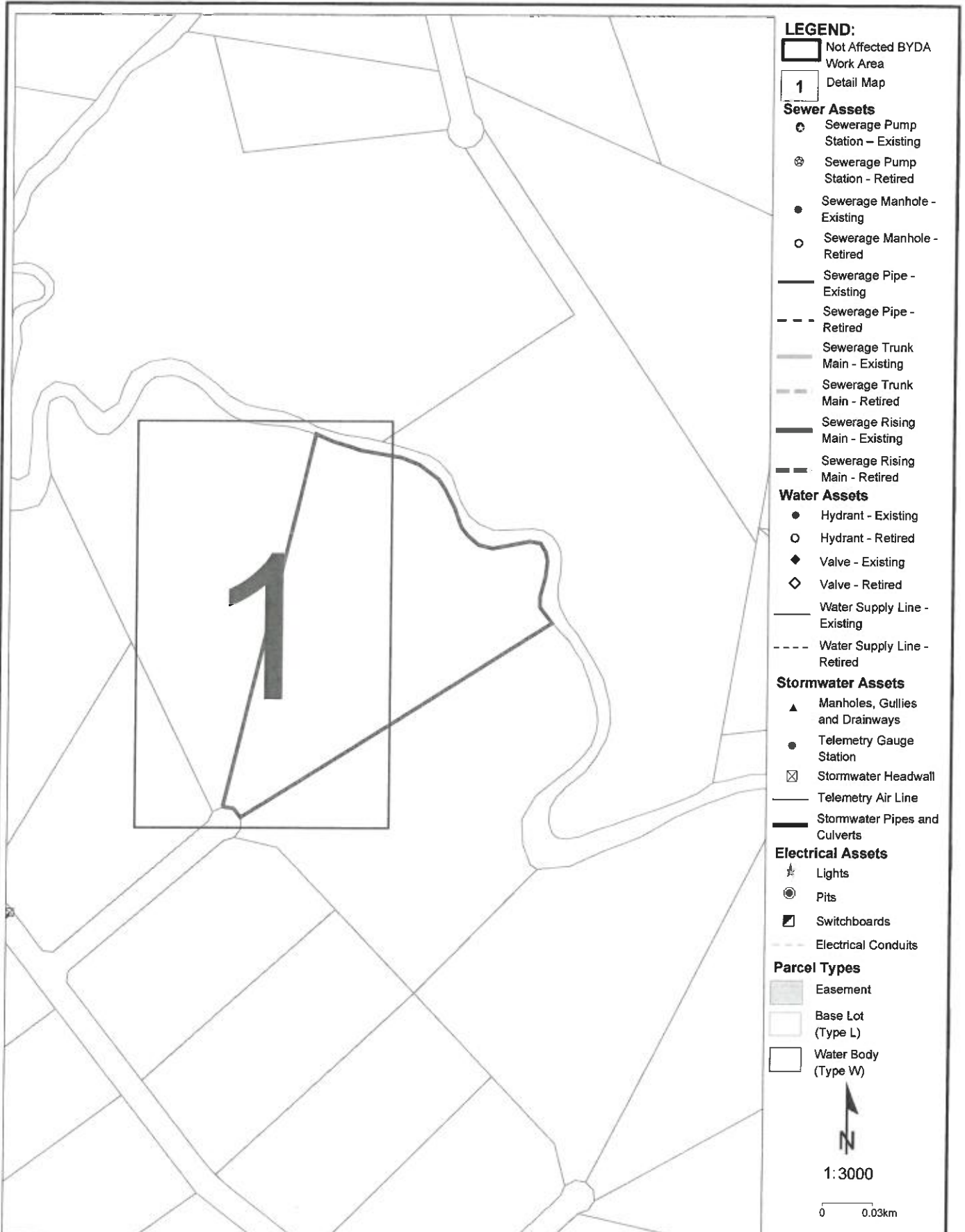

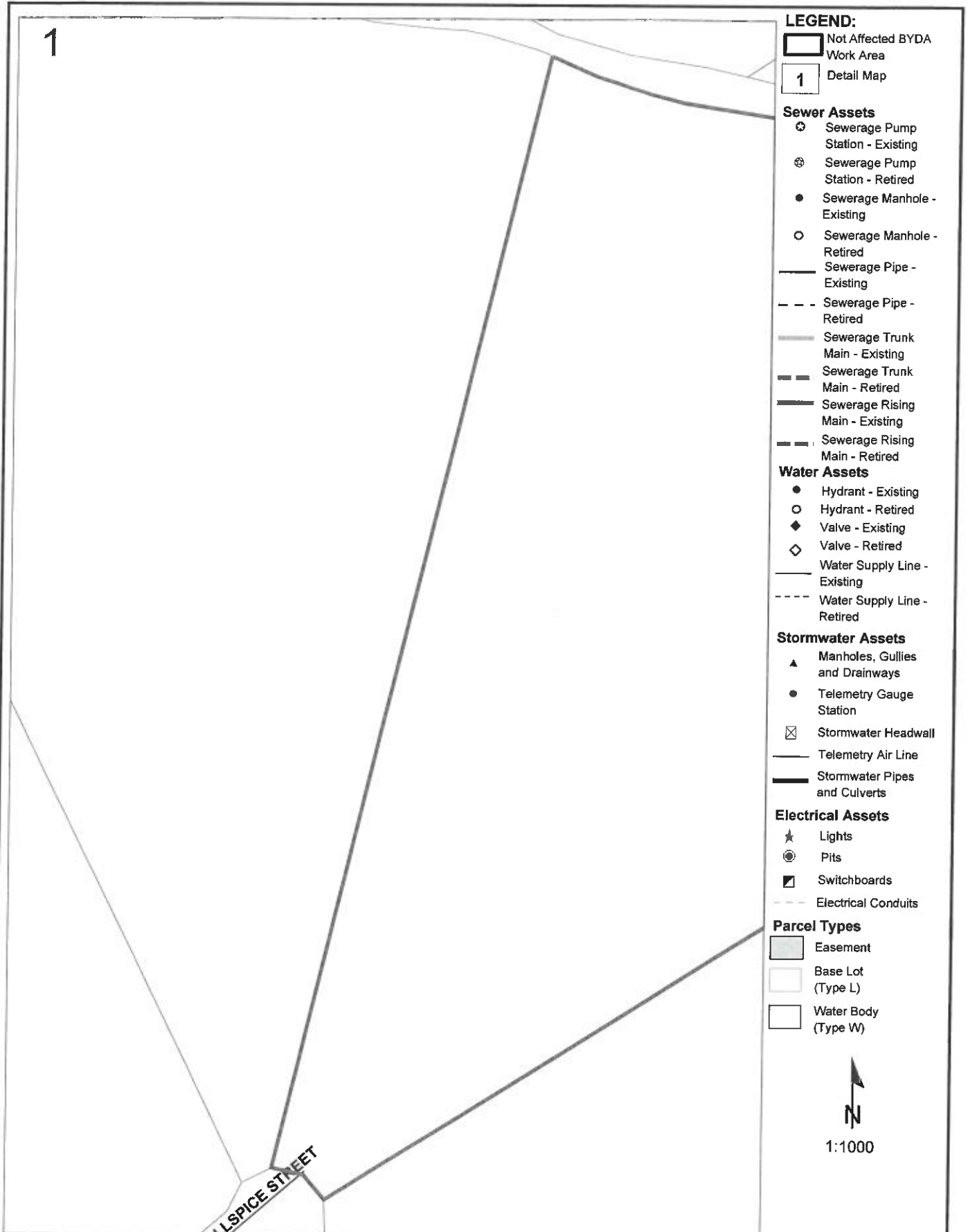

Disclaimer: The plans are indicative only and while all reasonable care has been taken in producing this information, Logan City Council does not warrant the accuracy, completeness or currency of this information and accepts no responsibility for, or in connection with any loss or damage suffered as a result of any inaccuracies, errors or omissions or your reliance on this information. Base material reproduced with permission of the Director-General, Department of Natural Resources and Mines. The State of Queensland (Department of Natural Resources and Mines).

Logan City Council's infrastructure dates back over many years and may include manufactured materials containing asbestos. You are solely responsible for ensuring that appropriate care is taken at all times and that you comply with all mandatory requirements relating to such matters, including but not limited to "workplace health and safety".













LEGEND:







 Not Affected BYDA Work Area

 Detail Map





Sewer Assets

-  Sewerage Pump Station - Existing
-  Sewerage Pump Station - Retired
-  Sewerage Manhole - Existing
-  Sewerage Manhole - Retired
-  Sewerage Pipe - Existing
-  Sewerage Pipe - Retired
-  Sewerage Trunk Main - Existing
-  Sewerage Trunk Main - Retired
-  Sewerage Rising Main - Existing
-  Sewerage Rising Main - Retired





Water Assets

-  Hydrant - Existing
-  Hydrant - Retired
-  Valve - Existing
-  Valve - Retired
-  Water Supply Line - Existing
-  Water Supply Line - Retired



Stormwater Assets

-  Manholes, Gullies and Drainways
-  Telemetry Gauge Station
-  Stormwater Headwall
-  Telemetry Air Line
-  Stormwater Pipes and Culverts

Electrical Assets

-  Lights
-  Pits
-  Switchboards
-  Electrical Conduits

Parcel Types

-  Easement
-  Base Lot (Type L)
-  Water Body (Type W)



1:1000

Disclaimer: The plans are indicative only and while all reasonable care has been taken in producing this information, Logan City Council does not warrant the accuracy, completeness or currency of this information and accepts no responsibility for, or in connection with any loss or damage suffered as a result of any inaccuracies, errors or omissions or your reliance on this information. Base material reproduced with permission of the Director-General, Department of Natural Resources and Mines. The State of Queensland (Department of Natural Resources and Mines).

Logan City Council's infrastructure dates back over many years and may include manufactured materials containing asbestos. You are solely responsible for ensuring that appropriate care is taken at all times and that you comply with all mandatory requirements relating to such matters, including but not limited to "workplace health and safety".



Before You Dig Australia

Think before you dig

This document has been sent to you because you requested plans of the Telstra network through Before You Dig Australia (BYDA).

If you are working or excavating near telecommunications cables, or there is a chance that cables are located near your site, you are responsible to avoid causing damage to the Telstra network.

Please read this document carefully. Taking your time now and following the **BYDA's Best Practices and 5 Ps of Safe Excavation** <https://www.byda.com.au/before-you-dig/best-practice-guides/>

can help you avoid damaging our network, interrupting services, and potentially incurring civil and criminal penalties.

Our network is complex and working near it requires expert knowledge. Do not attempt these activities if you are not qualified to do so.



Disclaimer and legal details

*Telstra advises that the accuracy of the information provided by Telstra conforms to Quality Level D as defined in AS5488-2013.

It is a criminal offence under the Criminal Code Act 1995 (Cth) to tamper or interfere with telecommunications infrastructure.

Telstra will also take action to recover costs and damages from persons who damage assets or interfere with the operation of Telstra's networks.

By receiving this information including the indicative plans that are provided as part of this information package you confirm that you understand and accept the risks of working near Telstra's network and the importance of taking all the necessary steps to confirm the presence, alignments and various depths of Telstra's network. This in addition to, and not in replacement of, any duties and obligations you have under applicable law.

When working in the vicinity of a telecommunications plant you have a "Duty of Care" that must be observed. Please read and understand all the information and disclaimers provided below.

The Telstra network is complex and requires expert knowledge to interpret information, to identify and locate components, to pothole underground assets for validation and to safely work around assets without causing damage. If you are not an expert and/or qualified in these areas, then you must not attempt these activities. Telstra will seek compensation for damages caused to its property and losses caused to Telstra and its customers. Construction activities and/or any activities that potentially may impact on Telstra's assets must not commence without first undertaking these steps. Construction activities can include anything that involves breaking ground, potentially affecting Telstra assets.

If you are designing a project, it is recommended that you also undertake these steps to validate underground assets prior to committing to your design.

This Notice has been provided as a guide only and may not provide you with all the information that is required for you to determine what assets are on or near your site of interest. You will also need to collate and understand all information received from other Utilities and understand that some Utilities are not a part of the BYDA program and make your own enquiries as appropriate. It is the responsibility of the entities arranging for the works to be performed, supervising the works, and undertaking the works to protect Telstra network during excavation / construction works.

Telstra owns and retains the copyright in all plans and details provided in conjunction with the applicant's request. The applicant is authorised to use the plans and details only for the purpose indicated in the applicant's request. The applicant must not use the plans or details for any other purpose.

Telstra plans or other details are provided only for the use of the applicant, its servants, agents, or CERTLOC Certified Locating Organisation (CLO). The applicant must not give the plans or details to any parties other than these and must not generate profit from commercialising the plans or details. If the Applicant is aware of another party or parties about to perform or performing works at the location, it should ensure that the other party or parties have lodged a BYDA enquiry and obtained plans for that location. If you are undertaking excavations works you must follow the 5Ps of Safe Excavation. The 5 Ps of Safe Excavation are set out in the video in the below link.

<https://www.byda.com.au/education/resources/>

Telstra, its servants or agents shall not be liable for any loss or damage caused or occasioned by the use of plans and or details so supplied to the applicant, its servants and agents, and the applicant agrees to indemnify Telstra against any claim or demand for any such loss or damage.

Please ensure Telstra plans and information provided always remains on-site throughout the inspection, location, and construction phase of any works.

Telstra plans are valid for 60 days after issue and must be replaced if required after the 60 days.

Data Extraction Fees

In some instances, a data extraction fee may be applicable for the supply of Telstra information. Typically, a data extraction fee may apply to large projects, planning and design requests or requests to be supplied in non-standard formats. For further details contact Telstra Location Intelligence Team.

Telstra does not accept any liability or responsibility for the performance of or advice given by a CERTLOC Certified Locating Organisation (CLO). Certification is an initiative taken by Telstra towards the establishment and maintenance of competency standards. However, performance and the advice given will always depend on the nature of the individual engagement.

Neither the Certified Locating Organisation nor any of its employees are an employee or agent for Telstra. Telstra is not liable for any damage or loss caused by the Certified Locating Organisation or its employees.

Once all work is completed, the excavation should be reinstated with the same type of excavated material unless specified by Telstra.

The information contained within this pamphlet must be used in conjunction with other material supplied as part of this request for information to adequately control the risk of potential asset damage.

When using excavators and other machinery, also check the location of overhead power lines.

Workers and equipment must maintain safety exclusion zones around power lines

WARNING: Telstra plans and location information conform to Quality Level 'D' of the Australian Standard AS 5488 - Classification of Subsurface Utility Information. As such, Telstra supplied location information is indicative only. Spatial accuracy is not applicable to Quality Level D. Refer to AS 5488 for further details. Telstra does not warrant or hold out that its plans are accurate and accepts no responsibility for any inaccuracy shown on the plans. **FURTHER ON SITE INVESTIGATION IS REQUIRED TO VALIDATE THE EXACT LOCATION OF TELSTRA PLANT PRIOR TO COMMENCING CONSTRUCTION WORK.** A plant location service is an essential part of the process to validate the exact location of Telstra assets and to ensure the assets are protected during construction works. The exact position of Telstra assets can only be validated by physically exposing them. Telstra will seek compensation for damages caused to its property and losses caused to Telstra and its customers.

Privacy Note

Your information has been provided to Telstra by BYDA to enable Telstra to respond to your BYDA request. Telstra keeps your information in accordance with its privacy statement. You can obtain a copy at www.telstra.com.au/privacy or by calling us at 1800 039 059 (business hours only).

General Information



Telstra highly recommends using Certified Locators.

For more info contact a **CERTLOC Certified Locating Organisation (CLO)** or **Telstra Location Intelligence Team 1800 653 935**



Before you Dig Australia – BEST PRACTISE GUIDES
<https://www.byda.com.au/before-you-dig/best-practice-guides/>



OPENING ELECTRONIC MAP ATTACHMENTS –

Telstra Cable Plans are generated automatically in either PDF or DWF file types. Dependent on the site address and the size of area selected. You may need to download and install free viewing software from the internet e.g.



DWF Map Files (all sizes over A3)
Autodesk Viewer (Internet Browser) <https://viewer.autodesk.com/> or
Autodesk Design Review <http://usa.autodesk.com/design-review/> for DWF files.
(Windows PC)



PDF Map Files (max size A3)
Adobe Acrobat Reader <http://get.adobe.com/reader/>



Telstra New Connections / Disconnections
13 22 00



Telstra Protection & Relocation: 1800 810 443 (AEST business hours only).

Email

Telstra Protection & Relocation Fact Sheet: [Link](#)

Telstra Protection & Relocation Home Page [Link](#)



Telstra Aerial Assets Group (overhead network)
1800 047 909

Protect our Network:

by maintaining the following distances from our assets:

- **1.0m Mechanical Excavators, Farm Ploughing, Tree Removal**
- **500mm Vibrating Plate or Wacker Packer Compactor**
- **600mm Heavy Vehicle Traffic (over 3 tonnes) not to be driven across Telstra ducts or plant.**
- **1.0m Jackhammers/Pneumatic Breakers**
- **2.0m Boring Equipment (in-line, horizontal and vertical)**

Cable Plan

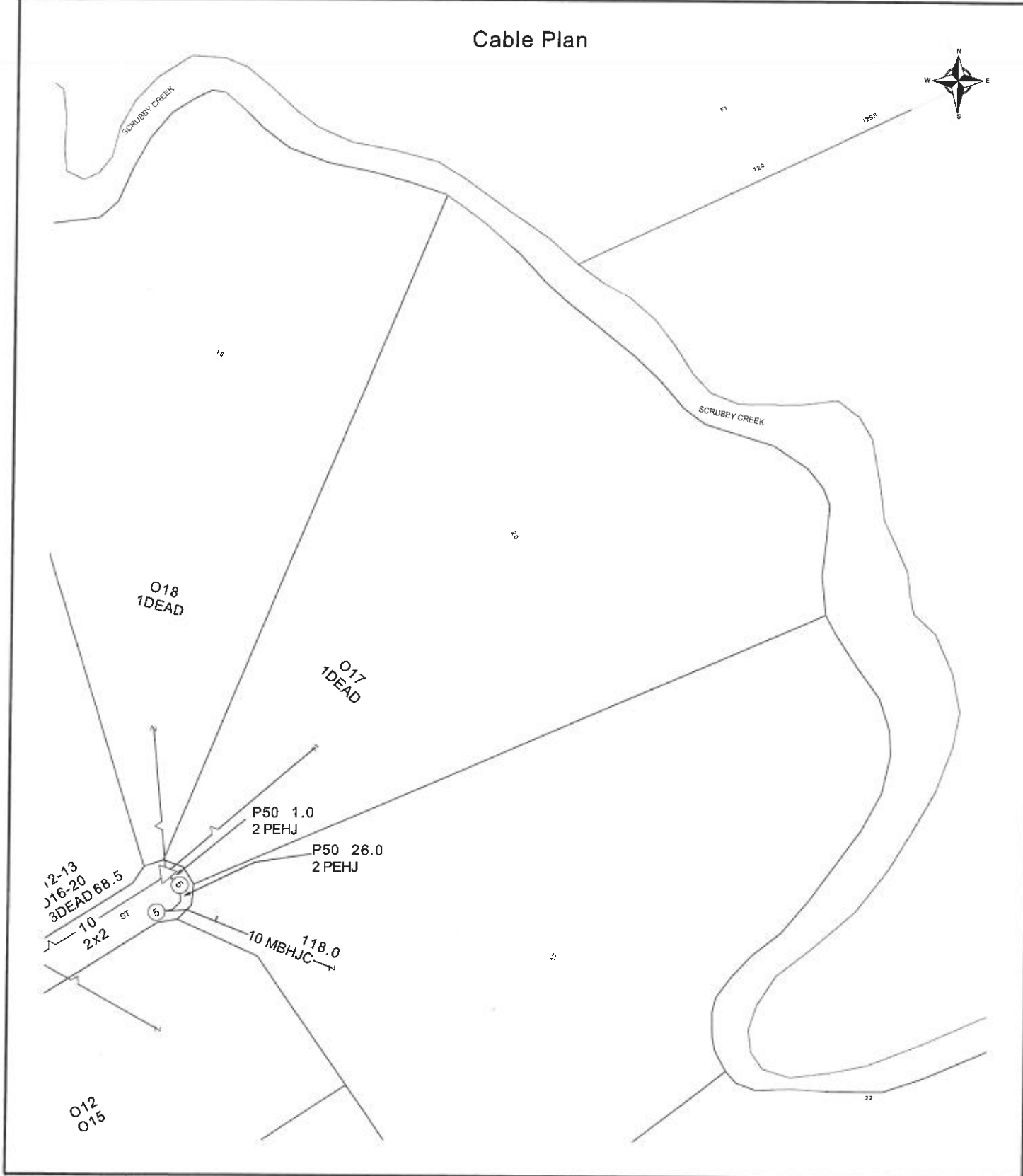

	Report Damage https://service.telstra.com.au/customer/general/forms/report-damage-to-telstra- Ph - 13 22 03 Email - Telstra.Plans@team.telstra.com Planned Services - ph 1800 653 935 (AEST bus hrs only) General Enquiries	Sequence Number: 269558359
	TELSTRA LIMITED A.C.N. 086 174 781 Generated On 11/03/2026 13:43:36	Please read Duty of Care prior to any excavating

WARNING
 Telstra plans and location information conform to Quality Level "D" of the Australian Standard AS 5488-Classification of Subsurface Utility Information. As such, Telstra supplied location information is indicative only. Spatial accuracy is not applicable to Quality Level D. Refer to AS 5488 for further details. The exact position of Telstra assets can only be validated by physically exposing it. Telstra does not warrant or hold out that its plans are accurate and accepts no responsibility for any inaccuracy. Further on site investigation is required to validate the exact location of Telstra plant prior to commencing construction work. A Certified Locating Organisation is an essential part of the process to validate the exact location of Telstra assets and to ensure the asset is protected during construction works.
 See the Steps- Telstra Duty of Care that was provided in the email response.



LEGEND

	Lead-in terminates at a Customer Address		Cable Jointing Pit Number / Letter indicating Pit type/size
	Exchange Major Cable Present		Elevated Joint (above ground joint on buried cable)
	Pillar / Cabinet Above ground Free Standing		Telstra Plant in shared Utility trench
	Above ground Complex Equipment Please note: Powered by 240v electricity		Aerial cable / or cable on wall
OC	Other Carrier Telecommunication Cable/ Asset. Not Telstra Owned		Aerial cable (attached to joint use Pole e.g., Power Pole)
DIST	Distribution cables in Main Cable Ducts		Marker Post Installed
MC	Main Cable ducts on a Distribution Plan		Buried Transponder
	Blocked or Damaged Duct		Marker Post & Transponder
	Footway Access Chamber (can vary between 1-lid to 12-lid)		Optical Fibre Cable Direct Buried
	NBN Pillar		Direct Buried Cable
	Third Party Owned Network Non-Telstra		nbn owned network

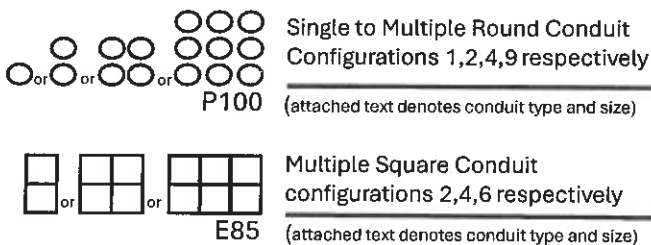

Some examples of conduit type and size:
 A - Asbestos cement, P - PVC / Plastic, C - Concrete,
 GI - Galvanised Iron, E - Earthenware
 Conduit sizes nominally range from 20mm to 100mm
 P50 50mm PVC conduit
 P100 100mm PVC conduit
 A100 100mm asbestos cement conduit

Some Examples of how to read Telstra Plans

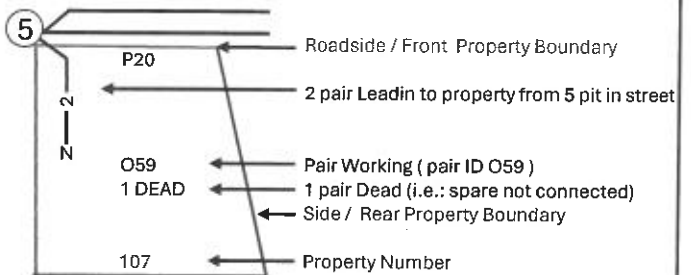
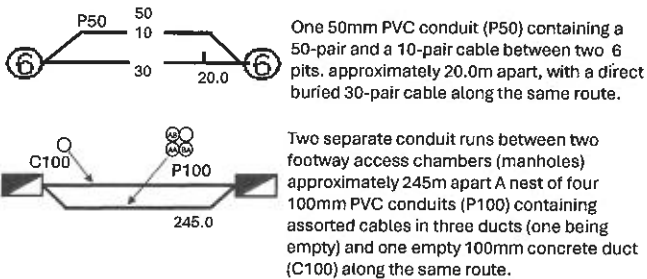

The 5 Ps of Safe Excavation

<https://www.byda.com.au/before-you-dig/best-practice-guides/>

Plan

Plan your job. Use the BYDA service at least one day before your job is due to begin, and ensure you have the correct plans and information required to carry out a safe project.

Prepare

Prepare by communicating with asset owners if you need assistance. Look for clues onsite. Engage a Certified Locator.

Pothole

Potholing is physically sighting the asset by hand digging or hydro vacuum extraction.

Protect

Protecting and supporting the exposed infrastructure is the responsibility of the excavator. Always erect safety barriers in areas of risk and enforce exclusion zones.

Proceed

Only proceed with your excavation work after planning, preparing, potholing (unless prohibited), and having protective measures in place.